



Vizualization

In-wall sliding doors

Experience modern design with our aluminum sliding doors, engineered for elegance and functionality. Designed to glide seamlessly, these doors vanish into the wall when opened, creating a clean, spacious look that enhances any architectural vision. With smooth, reliable operation, our sliding doors bring sophistication and convenience to any space, meeting the highest standards in both form and function.



- **Sleek, Modern Design** – Complements any contemporary architectural style.
- **Space-Saving Functionality** – Doors slide seamlessly into the wall for a clean, open look.
- **Space Maximization** – Ideal for smaller spaces or minimalist interiors.
- **High-Quality Aluminum Frame** – Durable and lightweight, perfect for frequent use.
- **Aesthetic, Narrow Sightline** - system profiles height: 65 mm
- **Automated Smooth Glide Mechanism** – Effortless operation for daily convenience.
- **Precision Engineering** – Ensures smooth, reliable performance every time.
- **Eco-Friendly Materials** – Aluminum frame is sustainable and recyclable.
- **Customizable Finishes** – Available in multiple finishes to match various interior styles - powder coating (RAL, NCS), anodizing.

Horizontal cross-section



Vertical cross-section

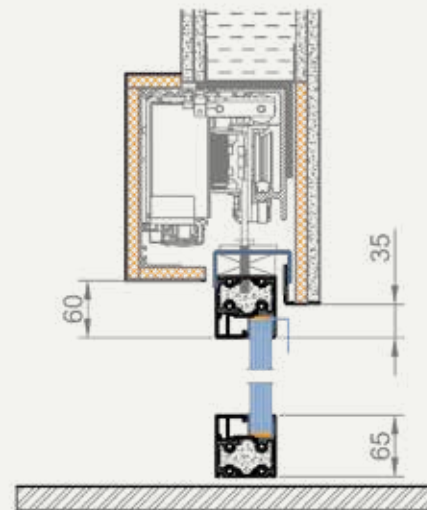

ALUFLAM A/S
Langebjergvænget 13
4000 Roskilde
DENMARK

Tel. +45 46 75 06 11
Fax +45 46 75 08 11
E-mail: info@aluflam.dk
VAT Reg No 20675136

ALUFLAM[®]
GROUP