



Vizualization

## Wall-mounted sliding doors

Our wall-mounted sliding doors blend sleek design with high functionality, gliding smoothly along the wall to save space without sacrificing style.

Crafted with a durable aluminium frame and engineered for quiet, seamless movement, these doors add a minimalist, refined touch to any space—ideal for projects that prioritize both aesthetics and efficiency.



- **Sleek, Modern Design** – Complements any contemporary architectural style.
- **Effortless Operation** – Smooth glide mechanism for easy daily use.
- **Space Maximization** – Ideal for smaller spaces or minimalist interiors.
- **High-Quality Aluminum Frame** – Durable and lightweight, perfect for frequent use.
- **Aesthetic, Narrow Sightline** - system profiles height: 65 mm
- **Automated Smooth Glide Mechanism** – Effortless operation for daily convenience.
- **Precision Engineering** – Ensures smooth, reliable performance every time.
- **Eco-Friendly Materials** – Aluminum frame is sustainable and recyclable.
- **Customizable Finishes** – Available in multiple finishes to match various interior styles - powder coating (RAL, NCS), anodizing.

Horizontal cross-section

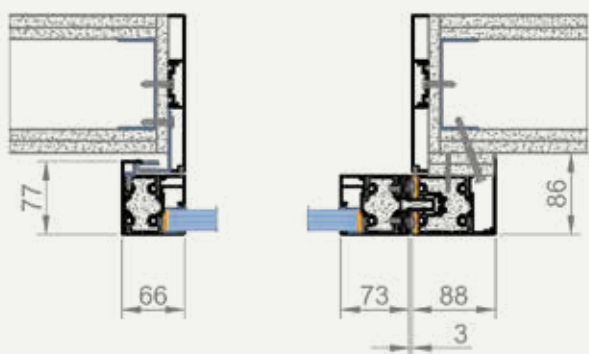

Vertical cross-section

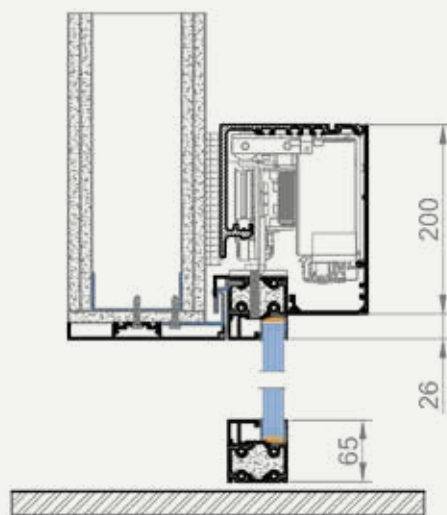

ALUFLAM A/S  
Langebjergvænget 13  
4000 Roskilde  
DENMARK

Tel. +45 46 75 06 11  
Fax +45 46 75 08 11  
E-mail: [info@aluflam.dk](mailto:info@aluflam.dk)  
VAT Reg No 20675136

**ALUFLAM**<sup>®</sup>  
GROUP