

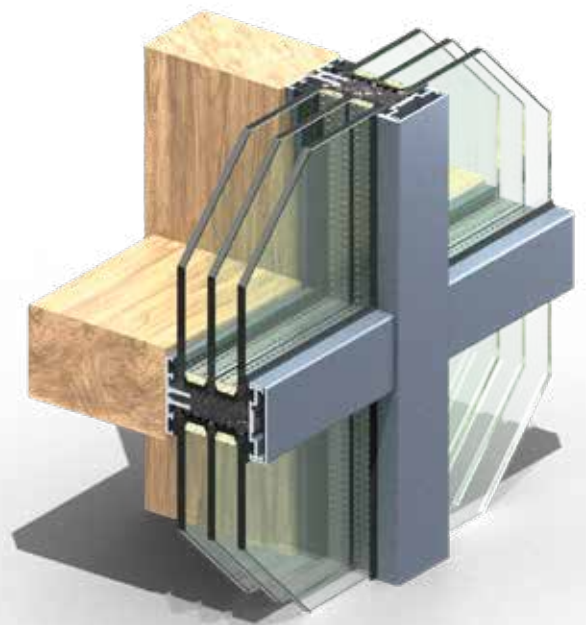

visualisation

Wooden Facade

The HOLZ™ is a wooden façade system that offers robust performance and a minimalist look. Experience harmony with nature and timeless design, ideal for commercial, public, and residential applications. This system enhances the aesthetic appeal of any building with its clean, subtle lines and seamless integration. Create stunning facades that blend natural beauty with enduring performance, perfect for a wide range of architectural styles with energy efficiency.



- Harmony with nature, timeless design
- Suitable for commercial, public and residential applications
- Enhances the appearance of the building with clean, subtle lines
- Aesthetic, narrow sightline of the system profiles: 50-60 mm
- Wooden mullion depth is available in the range: 50-350mm
- Large panes can be configured with this system
- Thermal isolation with value down to $U_m = 1.21$ [W/m²K] (infill panel 50mm)
- Easy integration with other façade systems
- Good sound resistance

Mullion

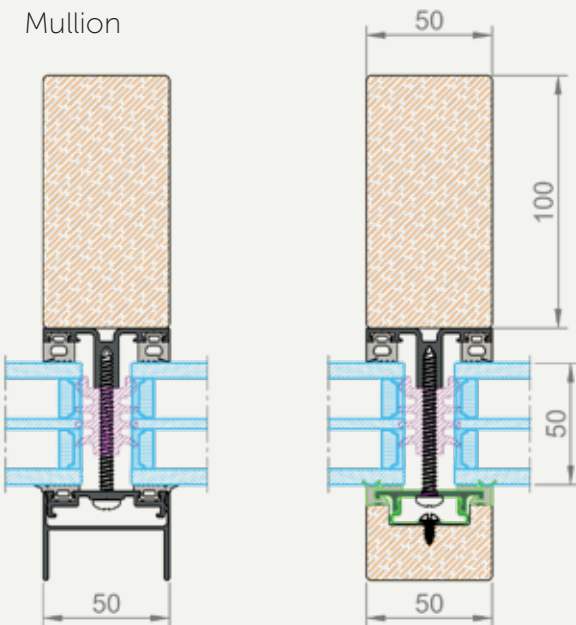

Transom

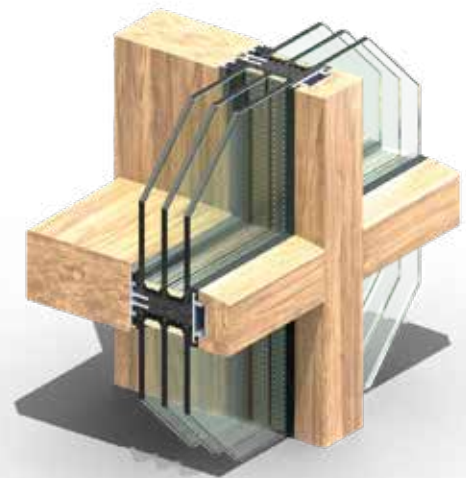
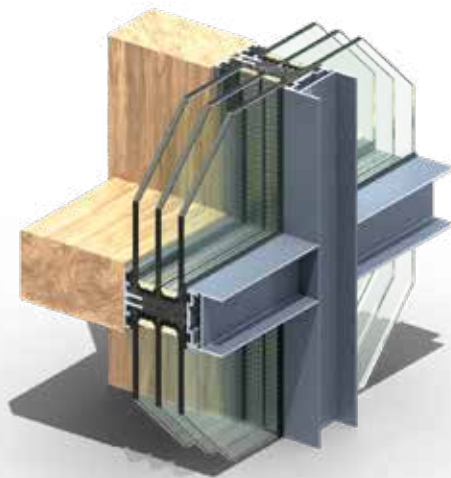
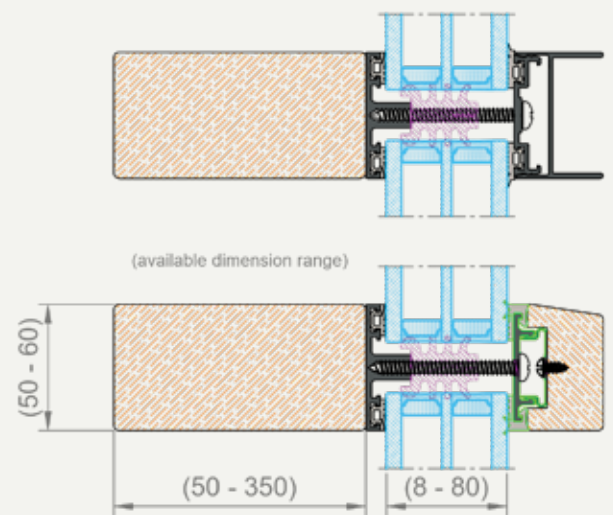

ALUFLAM A/S
Langebjergvænget 13
4000 Roskilde
DENMARK

Tel. +45 46 75 06 11
Fax +45 46 75 08 11
E-mail: info@aluflam.dk
VAT Reg No 20675136

ALUFLAM[®]
GROUP