

INSTALLATION MANUAL

AF50+ EVOLUTION

MANUAL SLIDING DOOR



Alufam Marine A/S
Langebjergvænget 13-15
DK 4000 Roskilde, Danmark
Tel. +45 46 75 06 11
Fax +45 46 75 08 11
E-mail: info@alufammarine.com
Web: <http://www.alufammarine.com/>



1 GENERAL NOTES

SYSTEM DESCRIPTION

- Extruded and filled aluminum framing, tested and approved by European NB - institutes.
- 50 mm frame depth
- Clear, fire-rated safety C-class glazing

REQUIRED TOOLS

Silicone caulking



Lifter



M6 countersink head bolt,
plastic insulator



Power drill with 7,5-8mm
drill and TX30, pozidriv head



Soft butyl tape

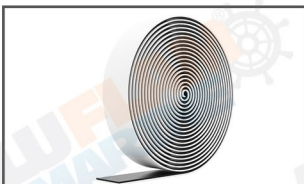

Lubricant spray



Soft butyl rod

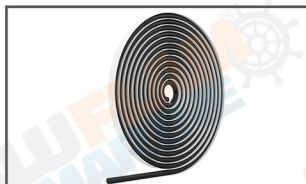

L-rack



Check to make sure that you have the necessary materials and tools necessary for the installation. Any material substitution must be of equal or greater quality.

Consult Aluflam Marine prior to substituting any material or for any other questions to ensure that the product's fire ratings and specifications are not violated.

The installation guide provides general instructions and does not address any conditions encountered.

Cutting tolerances are ± 1 mm unless otherwise specified.

All work must start from, and be referenced to benchmarks, offset lines and/or column centerlines established by the architectural drawings and the general contractor.

All frames must be installed plumb, square, level and in accordance with approved shop drawings. Glass and glazing building codes governing the design and use of products vary widely.

Aluflam Marine does not control the selection of the products for installation. Configurations, operating hardware and its function, or glazing materials are controlled by AFM.

It is the responsibility of the design professional, owner, architect or general contractor to provide structural underlay, framing in strict accordance with all applicable codes and project requirements.

System-to-structure fasteners are usually not supplied by Aluflam Marine or if so - they need to be requested by customer or by Aluflam Marine at the time of purchase order.

Fasteners called out on shop drawings usually show the tested and approved type and are to indicate minimum sizes.

1.1. Installation materials like sealants, bolts and screws are exw. Aluflam Marine works unless other specified in the project or shop drawings.

Screws or bolts must be suitable for substrate or wall to be confirmed from customer/yard.

1.2. Statically stable underlay, framing or walls are excluded Aluflam Marine works and (solutions are given just as advice) possible solutions can be consulted.

Aluflam Marine is not taking any responsibility for its statical stability.

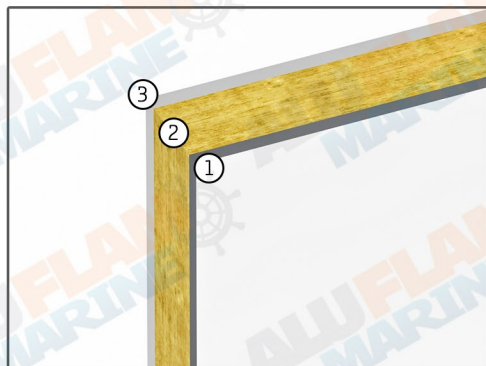

- 1.Steel frame
- 2.Insulating material
- 3.Covering panel

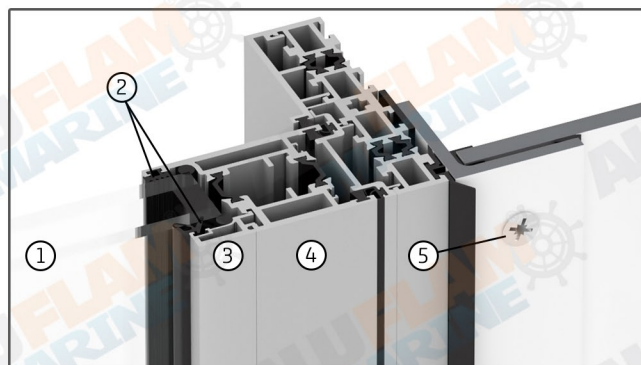

- 1. Glass
- 2. Glazing gasket
- 3. Glazing bead
- 4. Frame
- 5. M6 bolt

2 INSTALLATION

2.1. Unpacking Instructions

- 2.1.1. Carefully place the box with a crane on the deck onto an L-rack, keeping the upright position.



- 2.1.2. When the box is secured on the L-rack, remove the front and top covers. Carefully lift the frame out from the box.

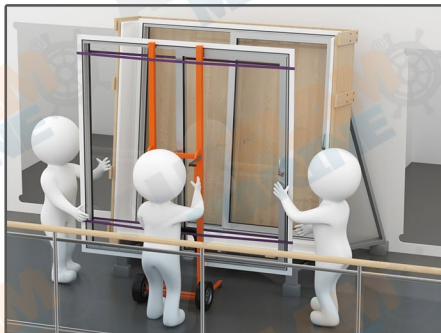

2.2. Installation of the frame

- 2.2.1. Clean the the frame opening and the doors counter frame with a wet rag. Place the soft butyl rod and soft butyl tape around the frame opening by pressing it to the surfaces.



2.2.2. Result shall look like this after all butyl sealants are on their place.

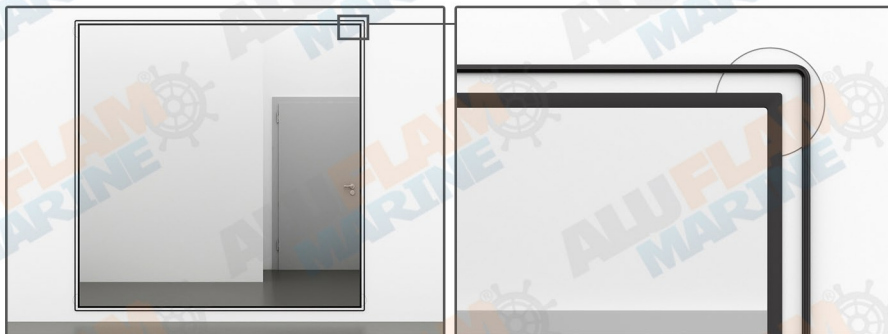

2.2.3. Drill the bolt locations into the surrounding structure using the factory pre-drilled frame holes as guides. Use a 7.5-8 mm drill. Fill the holes with silicone caulking.



2.2.4. Place the M6 bolts and the insulation shoes into the drilled locations

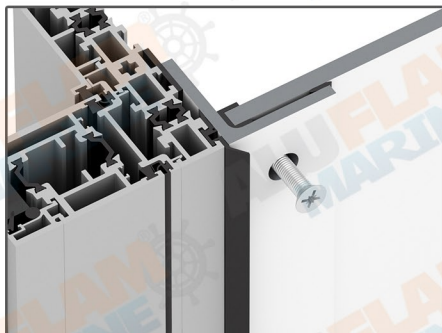

2.2.5. Fasten the bolts carefully so they do not destroy the plastic shoes.

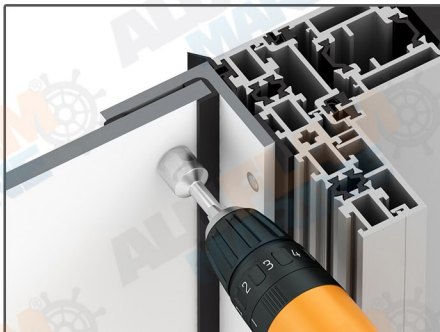
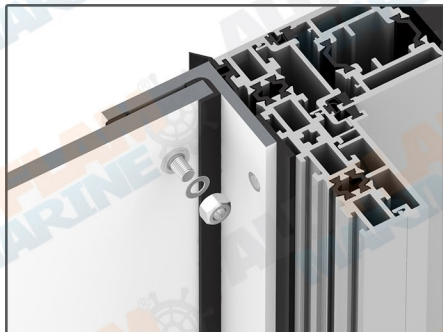

3 MAINTENANCE

3.1.1. Use lubricant spray like WD40 or similar twice a year on the mechanical parts of the door. To ensure maximum efficiency of the lubricant spray, carefully screw off the brush holder at the lower end of the door. Lubricate all mechanical parts also at the time of installation.



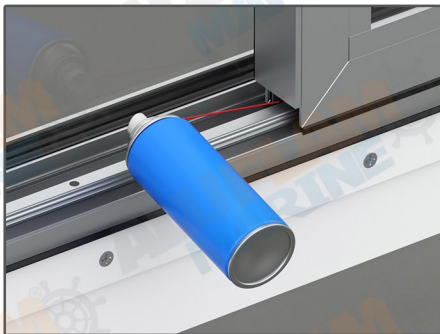

Please do not hesitate to contact us if you have any further questions or concerns.

Kind Regards

Aluflam Marine Team

Aluflam Marine A/S
 Langebjergvænget 13-15
 DK 4000 Roskilde, Danmark
 Tel. +45 46 75 06 11
 Fax +45 46 75 08 11
 E-mail: info@aluflammarine.com
 Web: <http://www.aluflammarine.com/>

